

ElectroShade® Motorized Shade System – Table of Contents

Table of Contents

Introduction	3.02
QSS™ and QSX™ –	
the Quiet Shade Systems™	3.03
ElectroShade Capability	3.04
ElectroShade Exploded View	3.05
ElectroShade Bracket Details	
Electro®/1 Bracket – Standard and Extended ...	3.06
Electro®/2 Bracket – Standard and Extended ...	3.06
Electro®/2 Extended Plus Bracket	3.07
Electro®/3 Bracket	3.07
Electro®/3 Extended Bracket	3.08
Electro®/3 Pocket Extended Bracket	3.08
Bracket Selector Guides	3.09 – 3.14
ElectroShade DoubleShade® Bracket Details	
Electro/3 DoubleShade Bracket #20	3.15
Electro/3 DoubleShade Bracket #21	3.16
Electro/1 DoubleShade Bracket #13	3.17
Electro/2 DoubleShade Bracket #17	3.18
Radius Center Support	
<16°	3.19
<45°	3.20
Components and Optional Accessories	3.21
Batten and Seam Specifications	3.22
ShadeWords	3.23
ElectroShade Hardware Features	
and Specifications	3.24 – 3.25
Warranty	3.26 – 3.27



The ElectroShade® Motorized Shade Systems



ElectroShade® was the first commercial-ized motorized shade system in which the motor resides within the roller tube (1976). ElectroShades are ideal for conference rooms and other VIP spaces, public spaces, high bay windows and atriums and where accessibility is a problem. Utilizing MechoShade Controls, ElectroShades can provide a uniform aesthetic appearance on the building facade, helping to protect the overall architectural design. They are also ideal for green building design, using AAC SolarTrac™ for controlled solar shading, maximizing daylighting and view, while reducing energy consumption caused by excessive solar heat-gain.

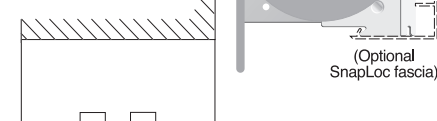

ElectroShades are available in 120VAC or 220/230VAC 50/60 Hz, meet all world-wide standards and can be controlled by a variety of standard and optional control systems.

ElectroShades have a Limited Lifetime Warranty on the hardware and shade cloth,



and a 5-Year Limited Warranty on all motors and electronics*.

ElectroShades feature:

❑ Energy-Conserving ShadeCloths.

ElectroShades offer the most extensive line of sun screens and blackout shade cloths in the industry. ThermoVeil®, EuroVeil® and EuroTwill™ Shade-Cloths provide visually transparent shading, with excellent glare control, energy savings and reduction in solar gain. Densities range from 0 to 15% openness factor, translucent to highly transparent. **Plus, we offer 96" (244cm) and 126" (320cm) SuperWide™ widths on select items.** (See Section 5 – ShadeCloths for details.)

❑ **DoubleShade® brackets** allow for both sun screens and blackout shades on a single bracket in a compact space for faster, easier, more economical installation of two shades per window.

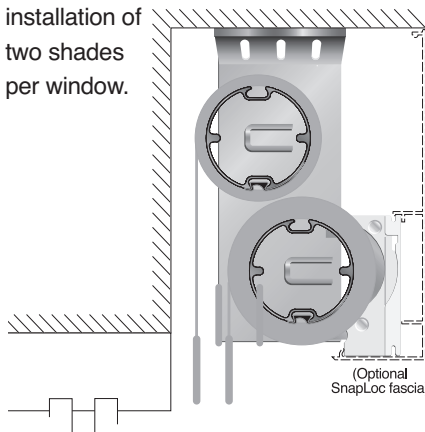

❑ **Multi-Band Operation** of up to 5 shade bands with a single motor for straight or faceted windows with up to 45° offset (22-1/2° each side) available.

❑ SnapLoc® Fascia (optional) —

Conceals the entire shade assembly and may be used as a continuous one-piece architectural element to cover one or more shadebands without exposed hardware.

❑ **SnapLoc® Spline** for easy installation, removal and cleaning of the shadebands without tape or glue and without having to remove the tube or brackets.

❑ Full Line of Optional Accessories.

Ceiling pockets, blackout sill and side channels and other optional accessories. (See Pockets and Room Darkening sections.)

❑ **Controls:** MechoShade Systems, Inc. offers controls designed to provide integrated solutions for Commercial, Lighting, A/V and Home Theatre. From sun activated, remote and wireless control, local and group control, mid-window alignment and specifiable intermediate stop positions to the ultimate in facade control and energy management.

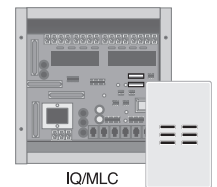

(*See Section 4: Control Systems.)

MechoShade Systems, Inc.
42-03 35th Street, Long Island City, NY 11101
Telephone: 718-729-2020
Fax: 718-729-2941 / 800-899-8081

E-mail: info@mechoshade.com
Internet Web Site: www.mechoshade.com

3.02
MS2200 - 01/01/08



Introducing QSS™ and QSX™ – The Quiet Shade Systems



Both, the QSS™ and the QSX™ ElectroShade Shading Systems are being used and tested in the New York Times headquarters mock-up in College Point Queens, NY.

New York Times Headquarters
– New York City, NY

Renzo Piano, Architect
Fox and Fowle, Local Architects
Gensler, Interior Architects

MechoShade® Systems, Inc., the leading provider of window management systems for over 35 years, has introduced acoustical changes across its entire ElectroShade® line. All ElectroShades will reduce noise by 40% or more. For additional noise reduction, the optional Quiet Shade System (QSS™) enhancements allow motorized shading systems to be 50 to 85 percent quieter than comparable, untreated systems. For an even quieter environment, our QSX™ option is being offered. The QSX decreases the noise level by OVER 85%.

Both, the QSS and the QSX technology takes the same, high quality, high torque motors that have been successfully utilized for over 30 years, and applies acoustic dampening and other techniques to reduce the sound of our motorized shades.

QSS builds upon the flexibility and time-tested reliability of MechoShade's ElectroShade motorized shade systems, making them equally at home in commercial office, health-care or residential applications. Coupled with MechoShade System's line of low voltage electronic controls, QSS incorporates assured alignment and automation through

a variety of control solutions and integration into third-party lighting, HVAC, A/V and BMS systems, as well as a variety of third-party decorative switches and user interfaces. QSS also supports the company's full range of mounting hardware, accommodating a variety of configurations including single-banded, multi-banded, DoubleShade™ and accessories such as its 4113 pockets, fascias and room darkening side channels.

ElectroShade with QSS have a 5-year non-depreciating warranty on motors and controls, and a Lifetime Limited Warranty on non-motorized components including shadecloth, tubes and hardware.

MechoShade Systems, Inc.
42-03 35th Street, Long Island City, NY 11101
Telephone: 718-729-2020
Fax: 718-729-2941 / 800-899-8081

E-mail: info@mechoshade.com
Internet Web Site: <http://www.mechoshade.com>

3.03
MS2200 - 01/01/08



Broad Range of ElectroShade® Capability

ElectroShades offer the most extensive range of solutions for your project requirements. ElectroShades can handle jobs large and small, angled windows, high bay windows and atriums where accessibility is a problem.

- ElectroShade's <16° and <45° Center Supports can accommodate angled or faceted bay window applications.
- ElectroShades can integrate with the IQ/MLC™ Mid-Window Alignment System, remote control, sun activated sensors and timers. They can also be integrated with the AAC SolarTrac™ computerized solar tracking system for the ultimate in controlled solar shading systems.
- Shade heights of up to 50 feet (1524cm) high are possible with custom brackets.

Electro®/1 and Electro®/2

- Electro/1 and 2 are available in Standard, Extended DoubleShade® bracket models with a 50mm tubular motor and the new RTS motor for wireless switch control.
- Shades up to 180" wide by 220" high (457cm W x 559cm H) are possible with Electro/1 and 2 Extended brackets
- Electro/2 is designed to work with our optional SnapLoc® Fascia to entirely conceal the shade assembly in an exposed installation.
- Mecho® Extended manual shades and Electro/2 motorized shades can be mixed under one continuous compact fascia.

Electro®/3

Electro/3 is ideal for smaller conditions which can show up anywhere including conference rooms, offices, cafes and boutiques, hospitals and residences.

- Electro/3 is available in Standard, Pocket, Extended and DoubleShade models with a 40mm tubular motor. (RTS not available)
- Shades up to 90" wide by 220" high (229cm W x 559cm H) are possible with Electro/3 Extended brackets.
- Electro/3's smaller size allows it to fit in tighter spaces, subject to maximum roll up diameters.
- Mecho® manual shades and Electro/3 motorized shades can be mixed under one continuous compact fascia.
- Electro/3 accepts blackout channels and most MechoShade accessories.

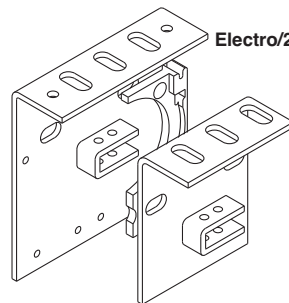

Electro/2

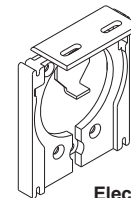

Electro/3



See pages 3.26 and 3.27 for full Warranty details.

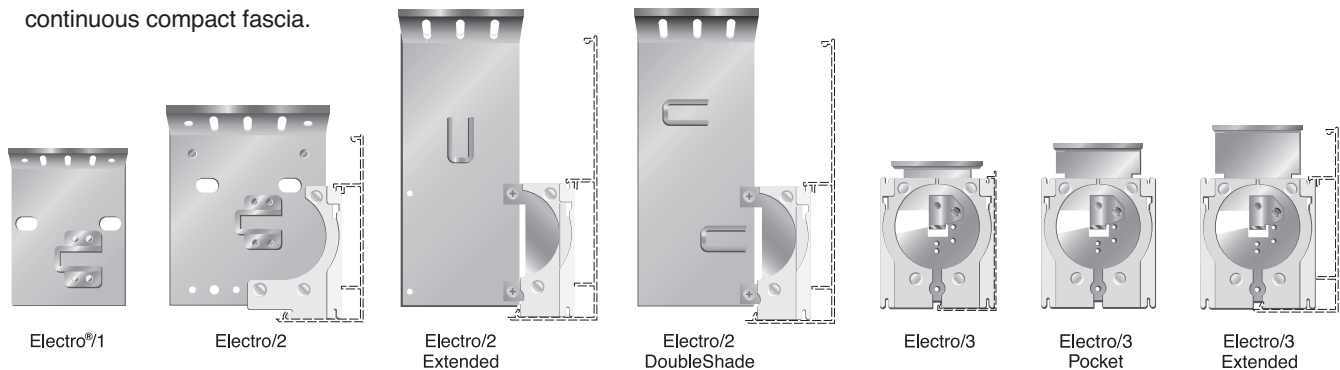

Bracket	Max. Roll Up Diameter With Fascia	Max. Roll Up Diameter No Fascia	Bracket Dimensions Without Optional Fascia, Roll Up Diameter or Wall Mount Bracket	
Electro®/1	N/A	4-1/4" (108mm)	2-7/8" W x 3-1/2" H	(73mm W x 89mm H)
Electro®/1 Extended	N/A	6-3/8" (162mm)	3" W x 7" H	(76mm W x 178mm H)
Electro®/2	4-1/4" (108mm)	N/A	4" W x 4-7/8" H	(114mm W x 124mm H)
Electro®/2 Extended	5-1/8" (130mm)	N/A	4-3/8" W x 7-5/16" H	(111mm W x 186mm H)
Electro®/2 Extended Plus	6-3/8" (162mm)	N/A	5-3/16" W x 7-5/16" H	(132mm W x 186mm H)
Electro®/3	2-3/4" (70mm)	2-3/4" (70mm)	3" W x 3-3/4" H	(76mm W x 95mm H)
Electro®/3 Pocket	N/A	4" (102mm)	3" W x 4-3/8" H	(76mm W x 111mm H)
Electro®/3 Extended	3-7/16" (87mm)	5" (127mm)	3" W x 4-7/8" H	(76mm W x 124mm H)

For DoubleShades® see the pages 3.15 – 3.18.

MechoShade Systems, Inc.
42-03 35th Street, Long Island City, NY 11101
Telephone: 718-729-2020
Fax: 718-729-2941 / 800-899-8081

E-mail: info@mechoshade.com
Internet Web Site: www.mechoshade.com



ElectroShade® Parts, Components & Optional Accessories

Multiband ElectroShades® exploded view and edge clearances

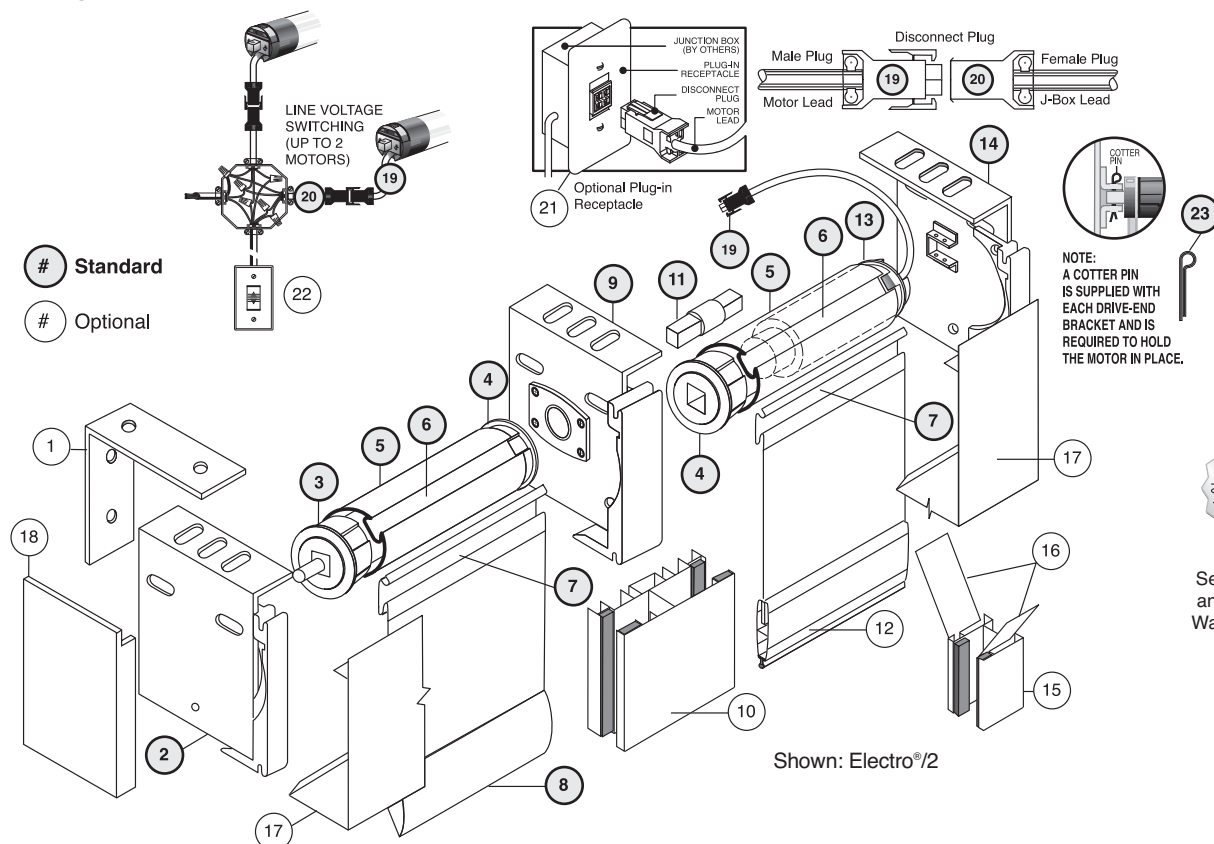

See pages 3.26 and 3.27 for full Warranty details.

Edge clearances

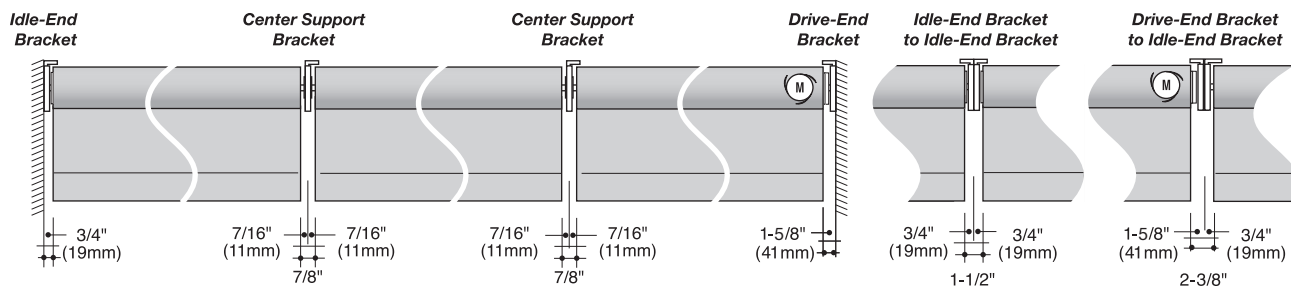

Shown: Electro®/3 Edge Clearances. For Electro®/1, /2 and all other Edge Clearances, see Section 10 pages 10.05 – 10.10 and 10.12 – 10.15.

ElectroShades are available in Electro/1, 2 and Extended sizes with a 50mm motor and Electro/3, Pocket and Extended sizes with a 40mm motor.

- | | | | |
|--|---|--|--|
| 1. Wall-Mount Angle | 8. Hembar (standard cloth covered) | 15. Room Darkening Side Channel (single with Polybond Light Seal) | 19. Motor Lead with Disconnect Plug (power plug) |
| 2. Idle-End Bracket | 9. Center Support Bracket | 16. Room Darkening ShadeCloth Guides (pair) | 20. J-Box Lead with Disconnect Plug |
| 3. Idle-End Tube Plug | 10. Room Darkening Center Channel (double with Polybond Light Seal) | 17. SnapLoc Regular-Roll Fascia | 21. Optional Plug-in Receptacle |
| 4. Tube Plug | 11. Tube Connector ("dog bone") | 18. Fascia End Caps (Electro/2, Electro/3 & Electro/3 Extended only) | 22. Low Voltage Control Systems |
| 5. SnapLoc® Tube (1-3/4", 2-1/2", 3-1/2" & 4-1/2" ø) | 12. Exposed Hemtube with Light Seal | | 23. Cotter Pin to hold motor in place |
| 6. SnapLoc Spline Mounting Channel | 13. Tubular Motor (A/C) | | |
| 7. SnapLoc Spline | 14. Drive-End Bracket | | |

Optional Regular-Roll Fascia available for: Electro/2, Electro/2 Extended, Electro/3 and Electro/3 Extended brackets.

Optional Reverse-Roll Fascia available for: Electro/3 and Electro/3 Extended brackets. • No Fascia Available: Electro/1, Electro /1 Extended and Electro/3 Pocket brackets.

For Edge Clearances of specific brackets see Section 10 of this binder.

MechoShade Systems, Inc.
42-03 35th Street, Long Island City, NY 11101
Telephone: 718-729-2020
Fax: 718-729-2941 / 800-899-8081

E-mail: info@mechoshade.com
Internet Web Site: www.mechoshade.com

604/2
REVISION
3.05
MS2200 - 01/01/08



ElectroShade® Details

Electro®/1 Bracket

Maximum roll up diameter:

4-1/4" (108mm). **Fascia not available.**

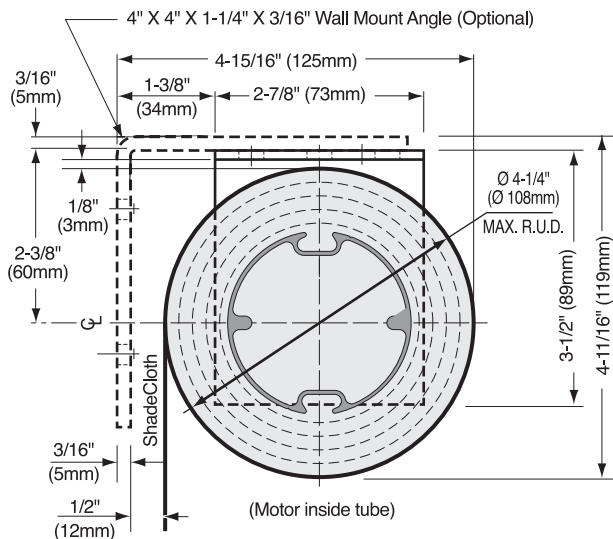

Electro®/2 Bracket

Maximum roll up diameter:

4-1/4" (108mm) **with optional fascia.**

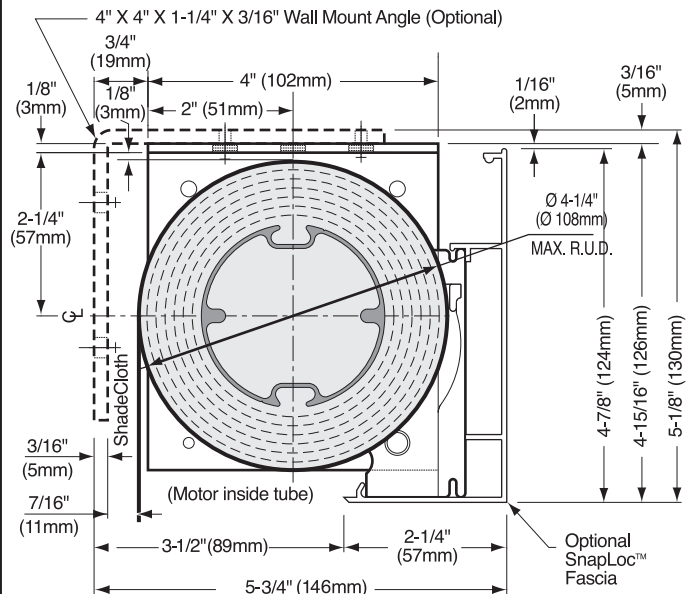

Electro®/1 Extended Bracket

Maximum roll up diameter:

6-3/8" (162mm). **Fascia not available.**

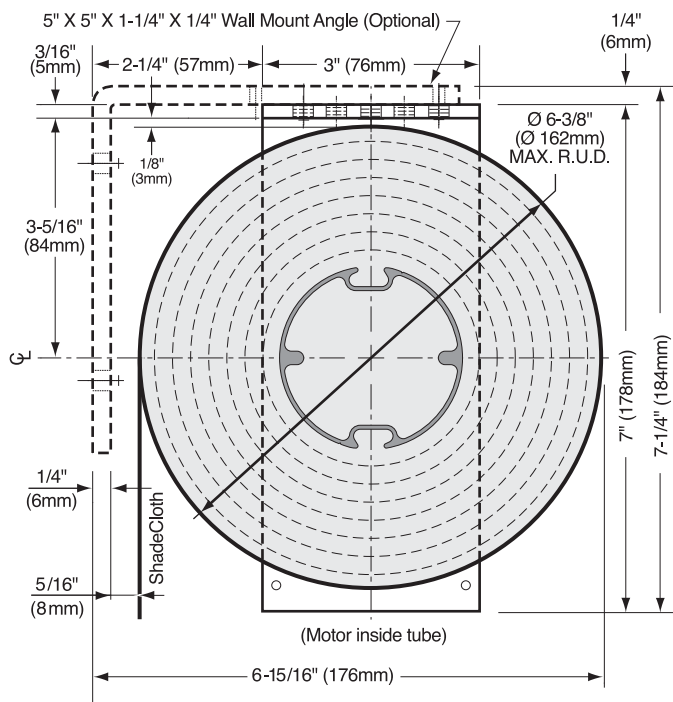

Electro®/2 Extended Bracket

Maximum roll up diameter:

5-1/8" (130mm) **with optional fascia.**

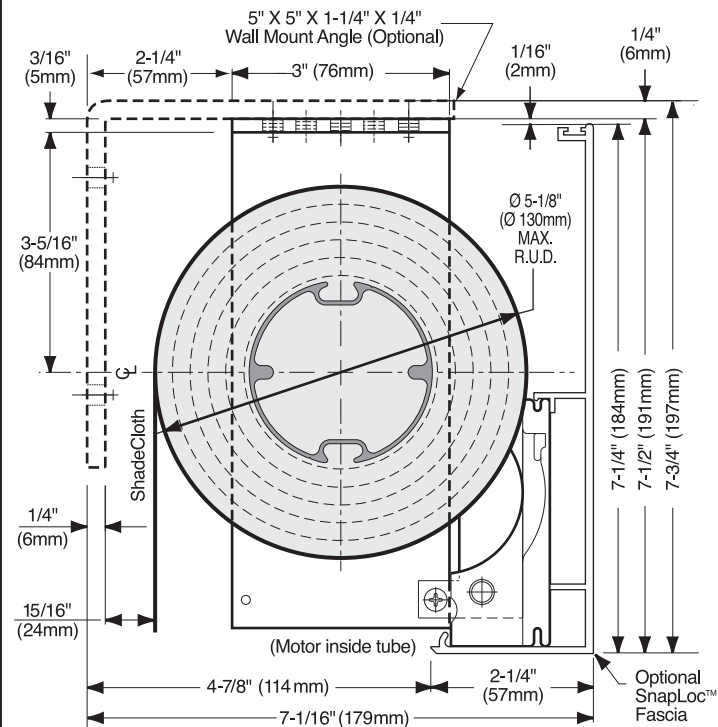

Continued

MechoShade Systems, Inc.
42-03 35th Street, Long Island City, NY 11101
Telephone: 718-729-2020
Fax: 718-729-2941 / 800-899-8081

E-mail: info@mechoshade.com
Internet Web Site: www.mechoshade.com

3.06
MS2200 - 01/01/08



